

continued.

N^{os}

Value in Current Money.

Brought Forward... \$ 11789.71

402: Lot Number Four Hundred, Two. Being a Farm in Anne Arundel County, comprising "Howards Improvement", "Hammonds Ridge", "Woodford" &c. Beginning for the same, on the first line of "Howards Improvement" at the distance of 7 1/4 Perches from the Beginning thereof, and at the end of the 1st line of a Parcel of Land conveyed by In^o. E. Howard to Jas. Frost 21st Nov^r. 1813. and running thence with said 1st line of Howards Improvement 1 S. 72° W. 18 3/4 Perches to a stone the Beginning of "Hammonds Ridge". thence 2 N. 11° E. 20 Perches binding on "Hammonds Ridge" to the main Road. thence binding on the Road 6 courses 3. N. 40° W. 18 Perches. 4. N. 54° W. 47 Perches. 5. N. 52° W. 32 Perches. 6. N. 40° W. 32 Perches. 7. N. 65° W. 30 Perches. 8. N. 51° W. 15 1/2 Perches. thence 9 S. 1° E. 82 1/2 Perches, binding on John Cords Land. thence 10 N. 81° 45' W. 12 Perches to the end of the 2^d line of "Howards Improvement" thence 11 N. 81° 45' W. 113 1/2 Perches. thence 12 N. 12° 15' E. 79 Perches to intersect the 1st line of "Jacks' Peacock". thence 13 S. 83° E. 22 Perches to the end of said line, thence with 2^d line of "Jacks' Peacock" 14 N. 4° E. 10 1/2 Perches to the Old Turnpike Road, thence up, and bending on the south side of said Road 15 N. 87° W. 39 1/2 Perches. 16 S. 87° W. 10 Perches. 17 S. 75° 30' W. 15 1/2 Perches to the 1st line of "Jacks' Peacock", thence binding thence 18 N. 83° W. 15 1/2 Perches to the beginning thereof. thence 19 S. 56° W. 48 Perches to Land conveyed by Parkin Shipley to In^o. E. Howard Jan^y 8th. 1817. thence with said Land 20 S. 165° W. 13 Perches 3 links to the beginning of Land conveyed by Sam^l. Howard to In^o. E. Howard, thence with said Land 7 courses. 21 N. 0° 30' E. 89 1/4 Perches. 22 N. 26° 30' E. 36 Perches 23 N. 6° W. 140 Perches 24 N. 38° 30' W. 100 Perches 25 N. 73° 30' W. 30 Perches. 26 S. 57° 30' W. 60 Perches. 27 S. 17° 30' W. 245 Perches to a stone on the south side of the Old Frederick Road, thence 28 S. 62° 15' E. 35 Perches to a White Oak at the end of the 2^d line of Land conveyed by In^o. E. Howard to Benj^m. Shipley. thence with said line reversed 29 S. 24° W. 59 1/2 Perches to the beginning thereof. thence with the 1st line of the said Shipley's Land, reversed 30 S. 165° W. 38 Perches to intersect the 10th line of "Howards Improvement". thence with said line 31. N. 87° W. 47 1/2 Perches to the end thereof. thence binding on "Howards Improvement" the following courses. 32. S. 2° E. 38 Perches 33. N. 77° 30' E. 32 1/4 Perches 34. S. 88° 30' E. 20 Perches. 35 S. 0° 30' W. 80 Perches. 36 S. 35° 30' E. 32 Perches 37. S. 67° 30' E. 12 Perches. 38 S. 10° 30' W. 30 Perches 39 S. 20° 30' W. 10 3/4 Perches 40. N. 87° 15' E. 267 Perches 41 S. 6° 15' E. 107 1/4 Perches. 42 S. 72° E. 100 Perches 43 N. 35° 15' E. 4 1/4 Perches 44 N. 22° E. 3 Perches. 45 N. 16° 30' E. 64 Perches 46 S. 70° 15' E. 36 1/2 Perches. 47 S. 16° E. 17 Perches 48 S. 70° 30' E. 238 Perches 49 N. 17° E. 150 Perches. thence with the given line of "Howards Improvement" 50 N. 51° W. 113 Perches to Land conveyed by In^o. E. Howard to Jas. Frost. thence with said Land 51 S. 49° W. 11 1/2 Perches, to the old Frederick Road. thence binding on the Road 52. N. 17° W. 32 1/4 Perches thence 53. N. 33° W. 57 Perches to the Beginning.

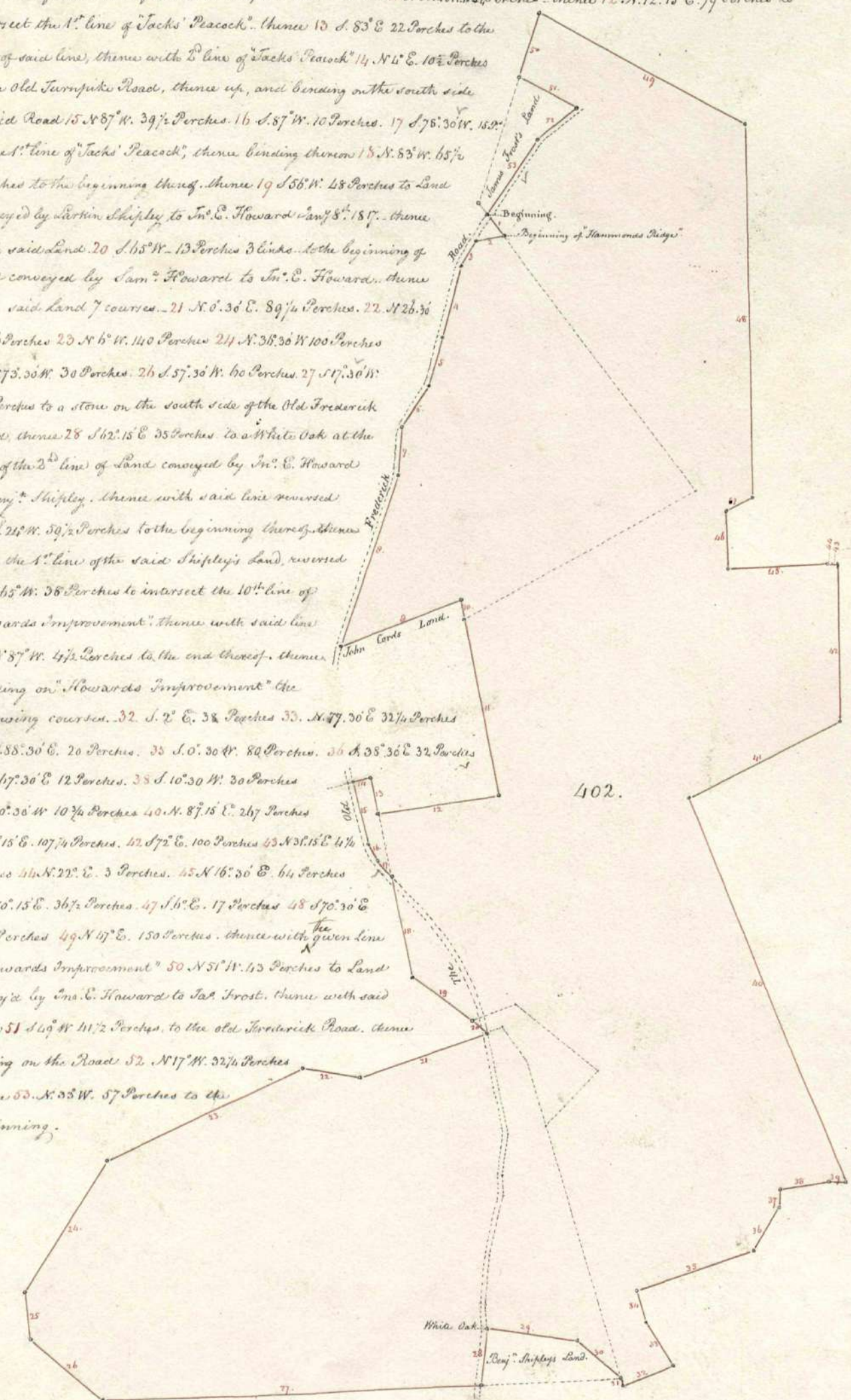

valued at . . . 14583. . .

An interest in a Lot in St. Paul's Burying Ground. valued at . . . 5. . .

Total Value of the Lot Property. . . \$ 131677.71